

ITEM NO.	PART NUMBER	DESCRIPTION	QTY.
1	1-149	WIDESPREAD VALVE LAV 16PT, HOT, ONLY	1
2	1-150	WIDESPREAD VALVE LAV 16PT, COLD, ONLY	1
3	10982	HOSE, 3/8" COMP. X 1/2" NPSM - 12'L	2
4	2-203	MOUNTING NUT KIT, WIDESPREAD LAV	2
4.1	92252	WASHER, 1-1/32" ID 1-13/16" OD	1
4.2	92251	HEX NUT, 1"-20 THREAD	1
5	3-330/00	SPOUT, BASIC II SERIES	1
5.1	1-112	TEE VALVE, 3/8" NPSM X 3/8" COMPRESSION	1
5.2	92174	WASHER MOUNT WIDESPREAD (3/8")	1
5.3	10746	NUT, 3/8"-18 NPSL	1
5.4	10550/00	ESCUTCHEON BASE, CONTEMP. BASIC II	1
5.5	90031	O-RING, 1-3/4"ID X 1/16"THK, AS-568-031	1
5.6	11163/00	SPOUT TUBE 3/4", LAV	1
5.7	10745	THREAD ALL, 3/8"-18 NPSL - 3/8"NPT	1
5.8	11428	AERATOR, CACHE TJ, 1.2GPM PCA PINK, 43.2260.450	1
6	3-339/00	SUB ASSY. LEVER HANDLE, BASIC II	2
6.1	11164/00	ESCUTCHEON BASE, CONTEMP. BASIC II	1
6.2	2-249/00	HANDLE LEVER, BASIC II	1
6.2.1	11167/00	BASE HANDLE, CONTEMP. BASIC II	1
6.2.2	11168/00	HANDLE LEVER, CONTEMP. BASIC II	1
6.2.3	92008	SET SCREW, CUP POINT 8-32, 3/16" L.	1
6.3	90031	O-RING, 1-3/4"ID X 1/16"THK, AS-568-031	1
7	3-545/00	BRASS PUSH TYPE DRAIN, W/ OVERFLOW & SMALL PLUG	1

- NOTE(S):
1. APPLY NSF COMPLIANT GREASE TO ANY O-RING, SEALING JOINTS, AND/OR PIVOTAL POINTS. G
  2. APPLY NSF COMPLIANT LOCTITE TO THREADED AREA. L

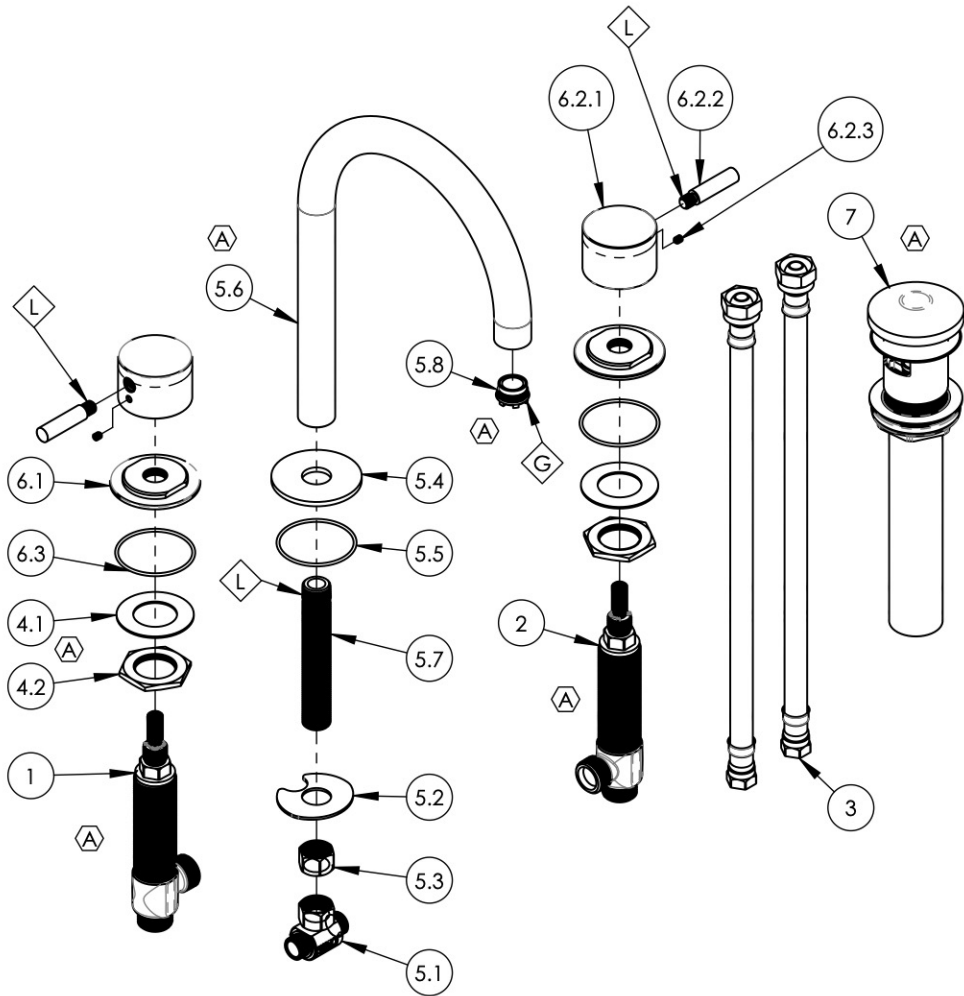

ALL	A	UPDATE TEMPLATE, REMOVE DRAIN PULL, UPDATE VALVES/ DRAIN/ AERATOR, ADD CALL OUTS	4/1/2020	AMM
ZONE	REV.	DESCRIPTION	DATE	APPROVED
REVISIONS				

1261 LOGAN AVENUE  
COSTA MESA, CALIFORNIA 92626  
PHONE: 714.361.4800  
FAX: 714.617.3120

**PHYLIRICH**<sup>®</sup>  
Defining Luxury Since 1959

**PROPRIETARY AND CONFIDENTIAL**  
THE INFORMATION CONTAINED IN THIS DRAWING IS THE SOLE PROPERTY OF PHYLIRICH. ANY REPRODUCTION IN PART OR AS A WHOLE WITHOUT THE WRITTEN PERMISSION OF PHYLIRICH IS PROHIBITED.

-	-	INTERPRET GEOMETRIC DIMENSIONING & TOLERANCING IN ACCORDANCE WITH ASME Y14.5-2009 & ASME Y14.41-2003 STANDARDS, UNLESS OTHERWISE SPECIFIED. DIMENSIONS ARE IN INCHES. TOLERANCES ARE:		
NEXT ASSY	USED ON	FRACTIONS ±1/16"	DECIMALS X.X: ±.1 X.XX: ±.01 X.XXX: ±.005	ANGULAR ±2°
APPLICATION		MATERIAL	NAME	DATE
FINISH		DRAWN	LLO	3/12/2015
DO NOT SCALE DRAWING		CHECKED	GRE	

**WIDESPREAD FAUCET, LEVER HANDLES, BASIC II**

SIZE **A** ASM/PRT NO. **230-04/00** REV **A**

SCALE: 1:4.5 WEIGHT: lbs. SHEET 1 OF 2